

Instruction Manual

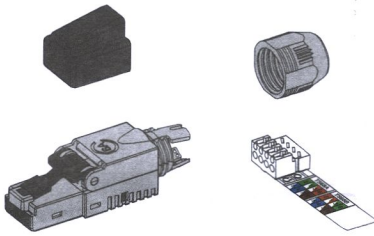

JACK PIN DESIGNATIONS	TIA/EIA T568A	TIA/EIA T568B	INDUSTRIAL
	1	White/Green	White/Orange
2	Green	Orange	Orange
3	White/Orange	White/Green	White
4	Orange	Green	Blue
5	Blue	Blue	
6	White/Blue	White/Blue	
7	White/Brown	White/Brown	
8	Brown	Brown	

- 1** Insert cable into screw type boot, strip off 1.2 inch of cable jacket, fold back the drain wire if use shielded cable.

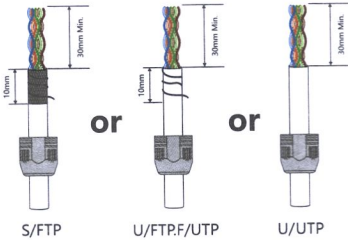

- 2** Fan out all four twisted pairs, following the color coding label and allocate each conductors into proper slots on wiring cap. Trim the ends of conductors.

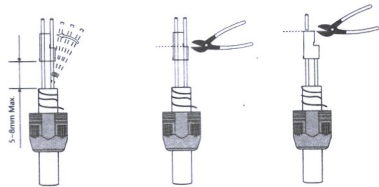

- 3** Remove the wiring label before place wiring cap on plug.

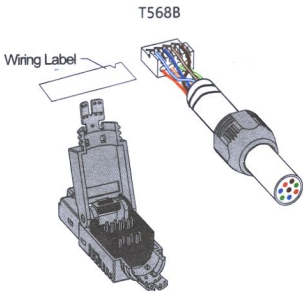

- 4** Place the wiring cap onto plug, use plier to clamp wiring cap until it completely snap-in to effect the connection.

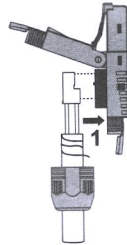

- 5** Close plug cover, make sure the drain wire is in proper contact with grounding clip on plug.

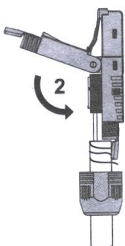

- 6** Tighten screw type boot to close the plug.

